



# INSTRUCTION BULLETIN

No. 340220  
Machine: 6200  
Published: 9-99/00  
System: OPTIONS

**NOTE: DO NOT DISCARD the Parts List from the Instruction Bulletin. Place the Parts List in the appropriate place in your machine manual for future reference. Retaining the Parts List will make it easier to reorder individual parts and will save you the cost of ordering an entire kit.**

*NOTE: Numbers in parenthesis ( ) are reference numbers for parts listed in Bill of Materials.*

Installation instructions for kit number 383969

## **SYNOPSIS / PROBLEM:**

This kit contains the parts needed to install a suspension seat kit on the model 6200 sweeper.

Please follow step-by-step instructions.

## **SPECIAL TOOLS / CONSIDERATIONS: NONE**

(Estimated time to complete: .5 hour)

## **PREPARATION:**

(Refer to FIG. 1, 2 and 3)

1. Shut off the machine and set the parking brake.

**FOR SAFETY: Before leaving or servicing machine, stop on level surface and set parking brake. Then turn off machine and remove key.**

## **INSTALLATION:**

(Refer to FIG. 1, 2 and 3)

1. Raise seat weldment and lock into position with seat prop rod.
2. Locate and remove standard seat mounting hardware under the seat mounting weldment.
3. Remove the standard seat from the seat mounting weldment.
4. Mount the new suspension seat (1) to the seat mounting weldment with four washers (2) and lock nuts (3).
5. Disengage the seat prop rod and lower the seat mounting weldment.
6. Check the suspension seat for proper operation.

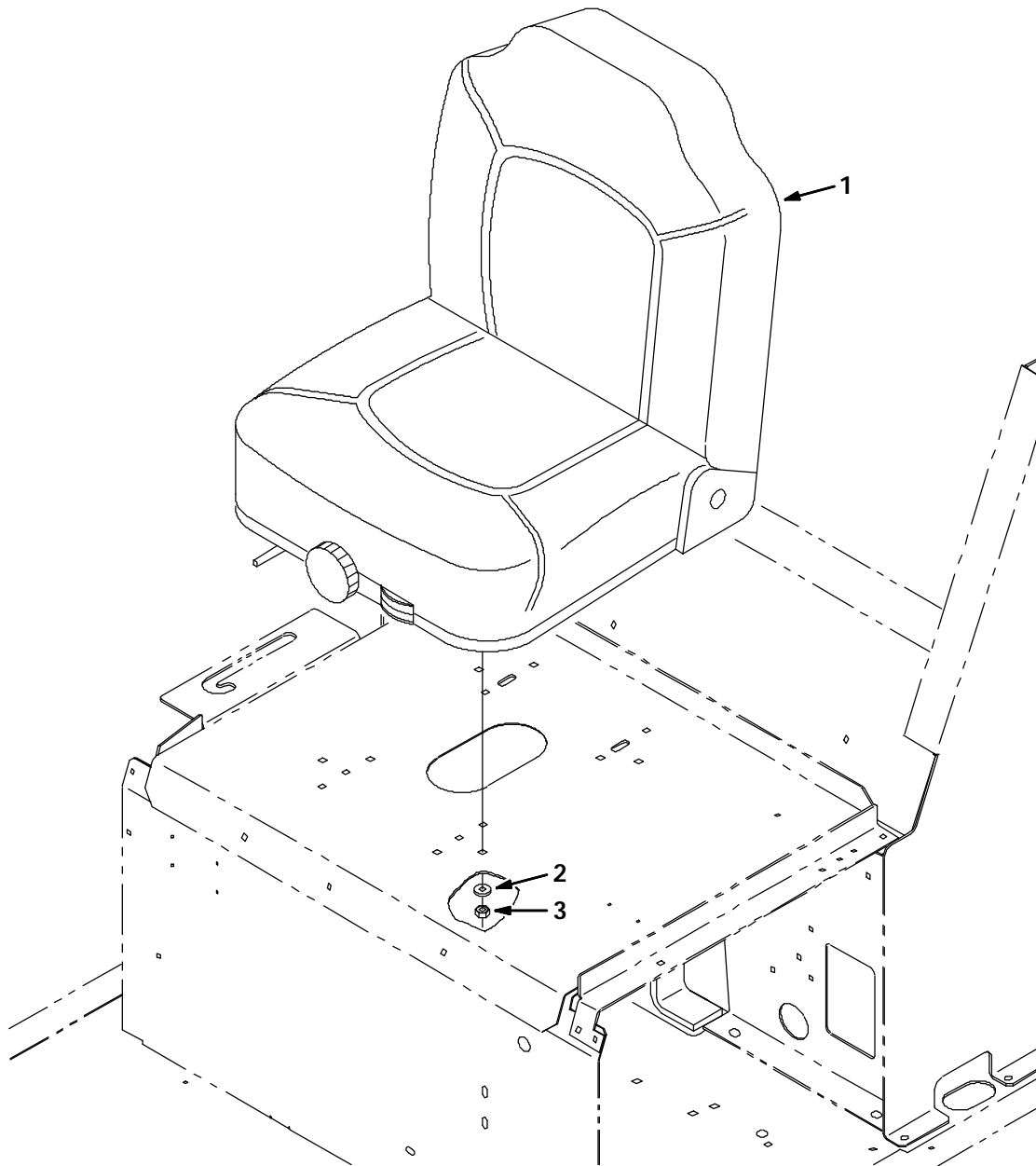

**FIG. 1 - SUSPENSION SEAT INSTALLATION**

**BILL OF MATERIALS FOR SUSPENSION SEAT KIT 383969**

Ref.	TENNANT Part No.	Description	Qty.
1	223595	Seat, suspensions	1
2	32491	Washer, flat	4
3	32983	Nut, hex, lock, .31-18,	4

TENNANT COMPANY  
P. O. Box 1452  
Minneapolis, MN 55440-1452